

PART NO.	DESCRIPTION	L1	L2
SK4091	MTB 29 NON BOOST	5.567in [141.4mm]	5.154in [130.9mm]
SK4093	MTB 29 BOOST	5.6772in [144.2mm]	5.1063in [129.7mm]
SK4069	FAT BIKE	7.252in [184.2mm]	6.681in [169.7mm]

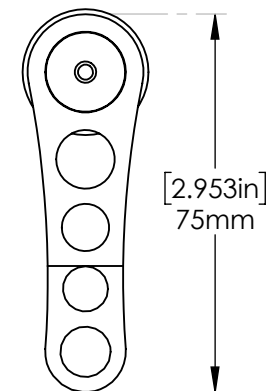
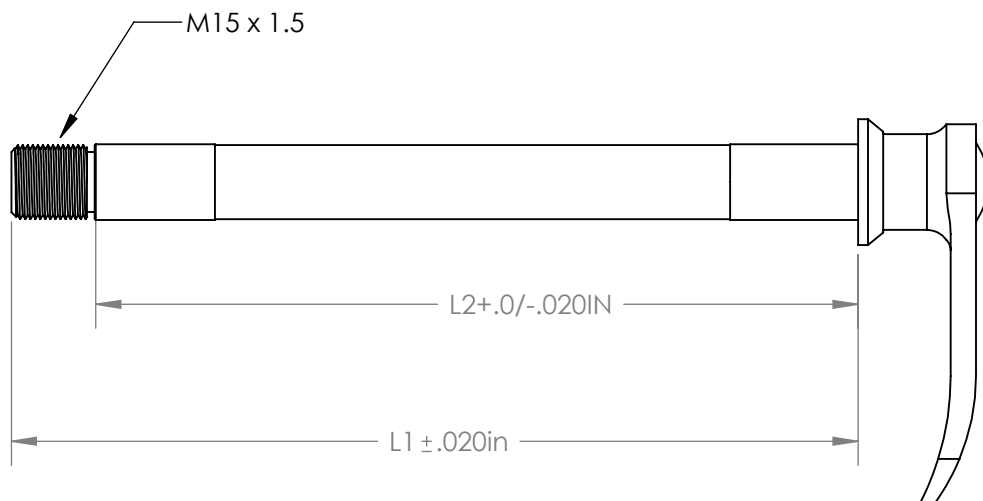
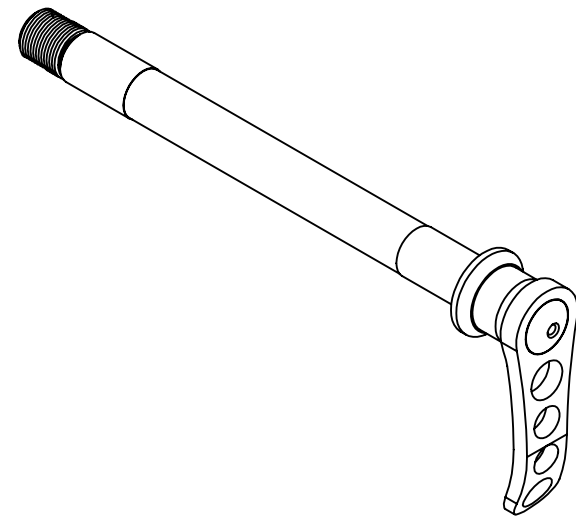

PARAGON MACHINE WORKS

TITLE: **PMW SPLINE HEAD
FRONT SKEWER,
ENVE FORK**

	NAME	DATE
DRAWN BY:	L.L	10/22
CHECKED BY:		

MATERIAL: 6061 ALUMINUM
GENERAL TOLERANCES:
X.X ± 0.020"
X.XX ± 0.010"
X.XXX ± 0.005"

**PROPRIETARY AND
CONFIDENTIAL**

THE INFORMATION CONTAINED IN THIS DRAWING IS PROVIDED FOR FRAMEBUILDERS AND IS THE PROPERTY OF PARAGON MACHINE WORKS. ANY REPRODUCTION IN PART OR AS A WHOLE WITHOUT THE WRITTEN PERMISSION OF PARAGON MACHINE WORKS IS PROHIBITED.

SIZE	DWG. NO.	REV
A	SK4091	A

SCALE: 1:1

SHEET 1 OF 1