

PART NO.	DESCRIPTION	L1	L2
SK4030	100 x M15 x 1.5	4.921in [125mm]	4.370in [111mm]
SK4031	110 x M15 x 1.5	5.315in [135mm]	4.764in [121mm]
SK4032	135 x M15 x 1.5	6.299in [160mm]	5.748in [146mm]
SK4033	142 x M15 x 1.5	6.575in [167mm]	6.024in [153mm]
SK4034	150 x M15 x 1.5	6.890in [175mm]	6.339in [161mm]

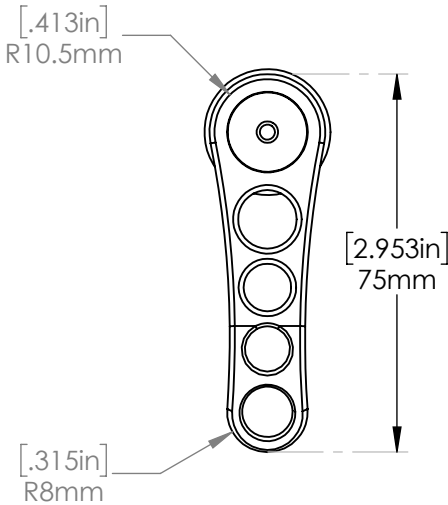
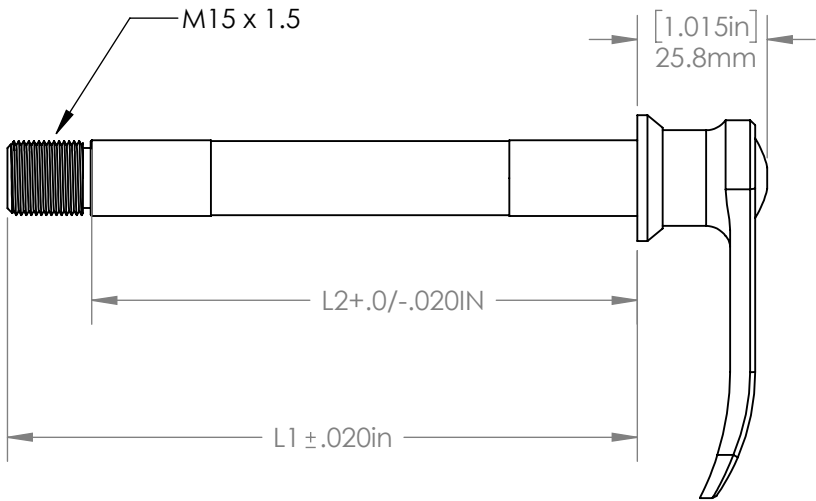
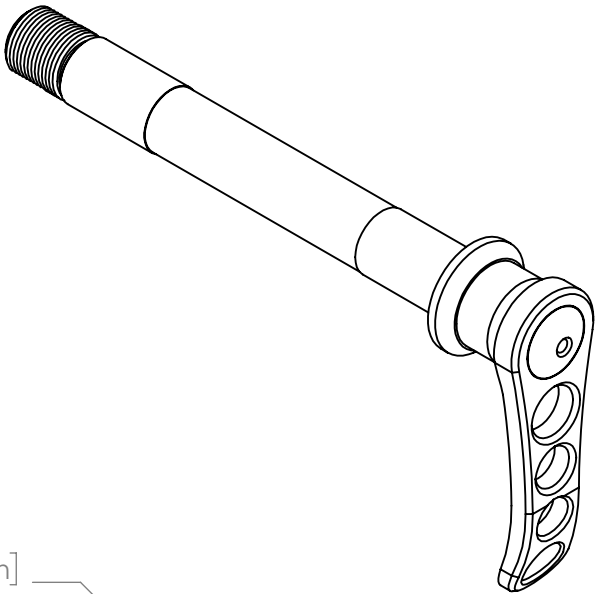

PARAGON MACHINE WORKS

TITLE: **PMW SPLINE HEAD
FRONT SKEWER,
M15x1.5**

SIZE	DWG. NO.	REV
A	SK403X	A

**PROPRIETARY AND
CONFIDENTIAL**

THE INFORMATION CONTAINED IN THIS
DRAWING IS PROVIDED FOR
FRAMEBUILDERS AND IS THE PROPERTY OF
PARAGON MACHINE WORKS. ANY
REPRODUCTION IN PART OR AS A WHOLE
WITHOUT THE WRITTEN PERMISSION OF
PARAGON MACHINE WORKS IS PROHIBITED.

	NAME	DATE
DRAWN BY:	DN	9/2018
CHECKED BY:	MCN	9/2018

MATERIAL: 6061 ALUMINUM
 GENERAL TOLERANCES:
 X.X ± 0.020"
 X.XX ± 0.010"
 X.XXX ± 0.005"