

PART NUMBER	DESCRIPTION	L	L2
SK4025	100 x 15mm	4.921in [125mm]	4.370in [111mm]
SK4026	110 x 15mm	5.315in [135mm]	4.764in [121mm]
SK4027	135 x 15mm	6.299in [160mm]	5.748in [146mm]
SK4028	142 x 15mm	6.575in [167mm]	6.024in [153mm]
SK4029	150 x 15mm	6.890in [175mm]	6.339in [161mm]

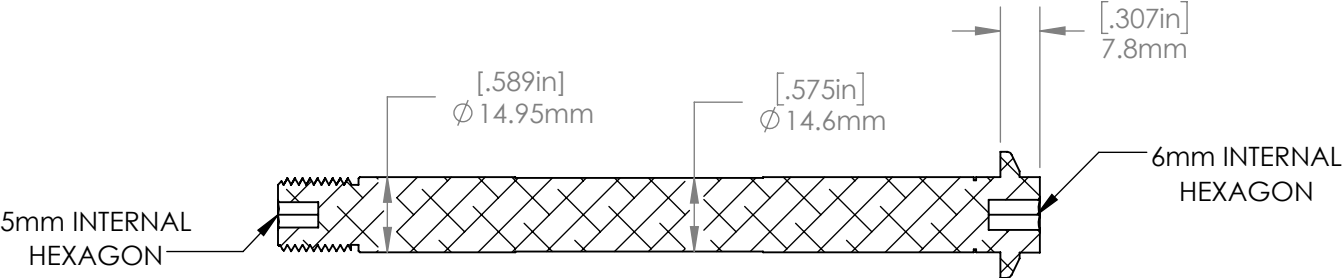

SECTION A-A
SCALE 1 : 1.5

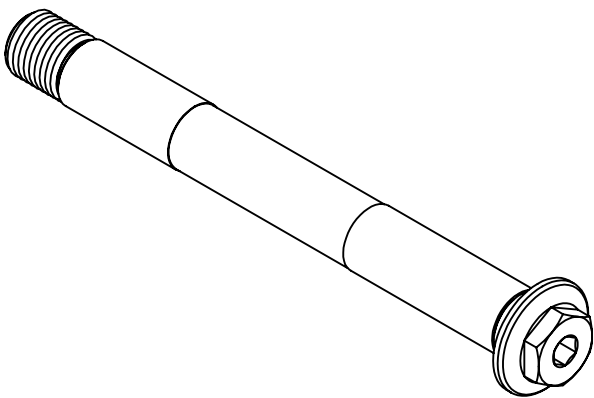
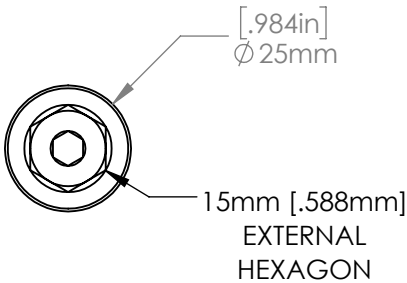
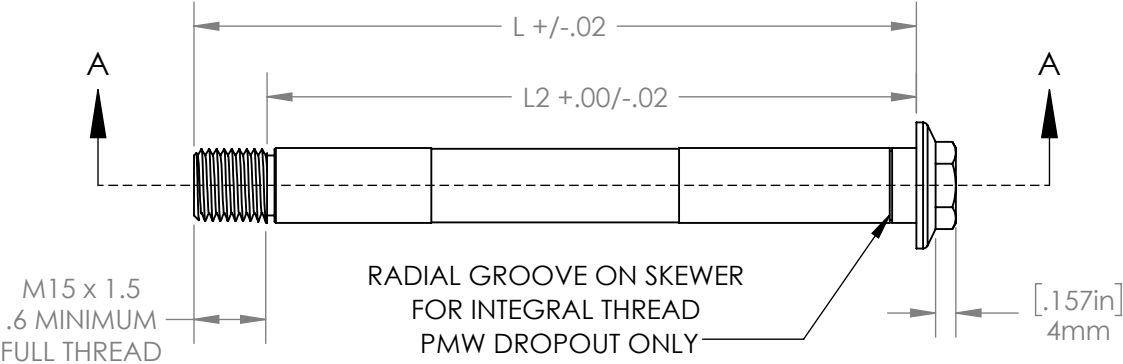

PARAGON MACHINE WORKS

TITLE: 15 MM COMBINATION
HEAD, FRONT SKEWER FOR
INTEGRAL THREAD
DROPOUT

SIZE	DWG. NO.	REV
A	SK402X	A1

**PROPRIETARY AND
CONFIDENTIAL**

THE INFORMATION CONTAINED IN THIS
DRAWING IS PROVIDED FOR
FRAMEBUILDERS AND IS THE PROPERTY OF
PARAGON MACHINE WORKS. ANY
REPRODUCTION IN PART OR AS A WHOLE
WITHOUT THE WRITTEN PERMISSION OF
PARAGON MACHINE WORKS IS PROHIBITED.

	NAME	DATE
DRAWN BY:	L.L	02/16
CHECKED BY:	MCN	02/16
MATERIAL: 6061 ALUMINUM		
GENERAL TOLERANCES:		
X.X ± 0.020"		
X.XX ± 0.010"		
X.XXX ± 0.005"		