

PART NUMBER	DESCRIPTION	L	L2
SK4025	100 x 15mm	4.921in [125mm]	4.370in [111mm]
SK4026	110 x 15mm	5.315in [135mm]	4.764in [121mm]
SK4027	135 x 15mm	6.299in [160mm]	5.748in [146mm]
SK4028	142 x 15mm	6.575in [167mm]	6.024in [153mm]
SK4029	150 x 15mm	6.890in [175mm]	6.339in [161mm]

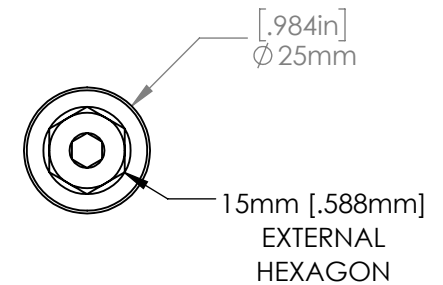
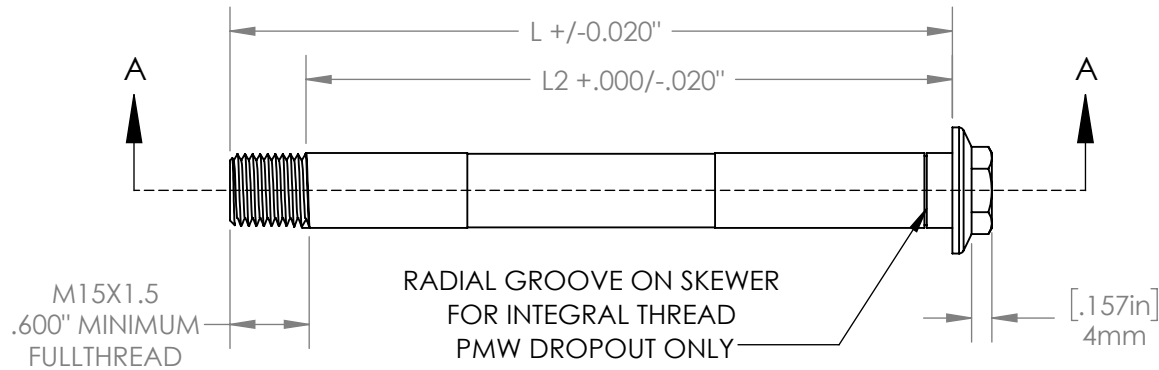
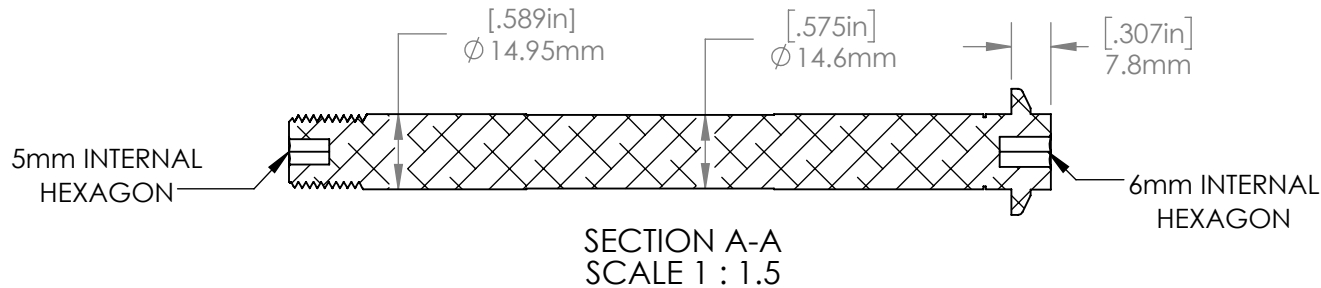
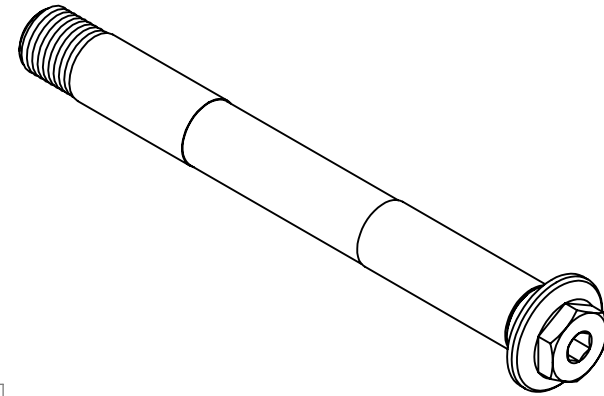

PARAGON MACHINE WORKS

TITLE: 15 MM COMBINATION
HEAD, FRONT SKEWER FOR
INTEGRAL THREAD
DROPOUT

	NAME	DATE
DRAWN BY:	L.L	02/16
CHECKED BY:	MCN	02/16

PROPRIETARY AND CONFIDENTIAL

THE INFORMATION CONTAINED IN THIS DRAWING IS PROVIDED FOR FRAMEBUILDERS AND IS THE PROPERTY OF PARAGON MACHINE WORKS. ANY REPRODUCTION IN PART OR AS A WHOLE WITHOUT THE WRITTEN PERMISSION OF PARAGON MACHINE WORKS IS PROHIBITED.

MATERIAL: 6061 ALUMINUM
GENERAL TOLERANCES:
X.X ± 0.020"
X.XX ± 0.010"
X.XXX ± 0.005"

SIZE	DWG. NO.	REV
A	SK4025	A1

SCALE: 2:3

SHEET 1 OF 2