

PART #	DESCRIPTION	L1	L2
SK4001	100 x 12mm	4.685in [119mm]	4.331in [110mm]
SK4002	110 X 12mm	5.079in [129mm]	4.724in [120mm]

M12 x 1.5  
MAJOR DIA .4712/.4619

5mm INTERNAL  
HEXAGON  
.350in DEEP

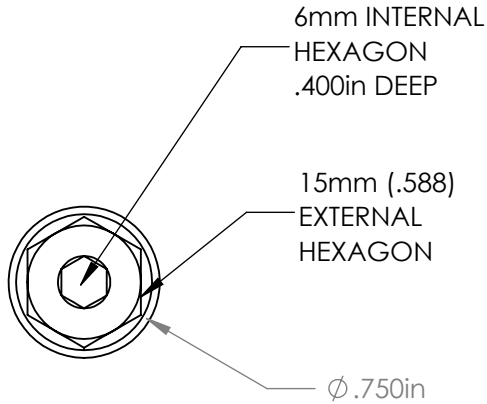
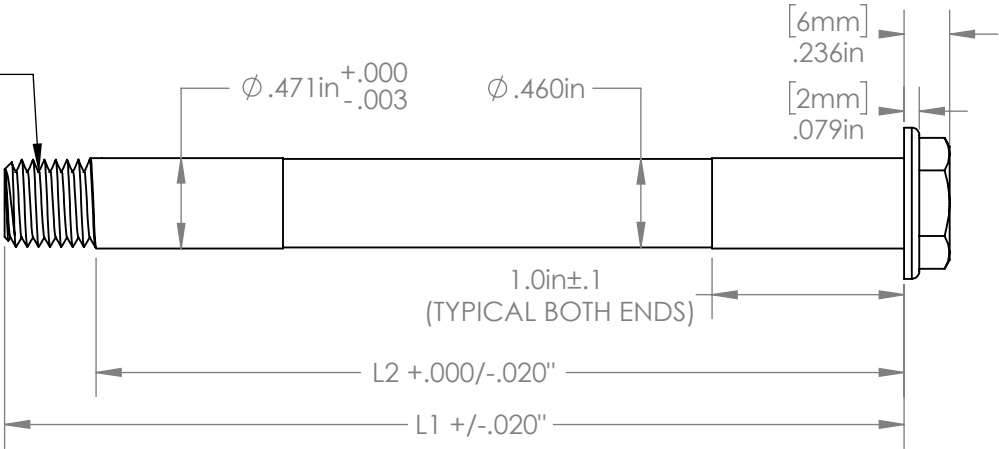

**PROPRIETARY AND  
CONFIDENTIAL**

THE INFORMATION CONTAINED IN THIS  
DRAWING IS PROVIDED FOR  
FRAMEBUILDERS AND IS THE PROPERTY OF  
PARAGON MACHINE WORKS. ANY  
REPRODUCTION IN PART OR AS A WHOLE  
WITHOUT THE WRITTEN PERMISSION OF  
PARAGON MACHINE WORKS IS PROHIBITED.

	NAME	DATE
DRAWN BY:	DN	9/2018
CHECKED BY:	MCN	9/2018

MATERIAL: 6061 ALUMINUM  
GENERAL TOLERANCES:  
X.X  $\pm 0.020"$   
X.XX  $\pm 0.010"$   
X.XXX  $\pm 0.005"$

**PARAGON MACHINE WORKS**

TITLE:

**12mm COMBINATION  
HEAD FRONT SKEWER**

SIZE	DWG. NO.	REV
<b>A</b>	<b>SK4001_2</b>	<b>A2</b>

SCALE: 1:1

SHEET 1 OF 1