

PART #	DESCRIPTION	L1	L2
SK4001	100 x 12mm	4.685in [119mm]	4.331in [110mm]
SK4002	110 X 12mm	5.079in [129mm]	4.724in [120mm]

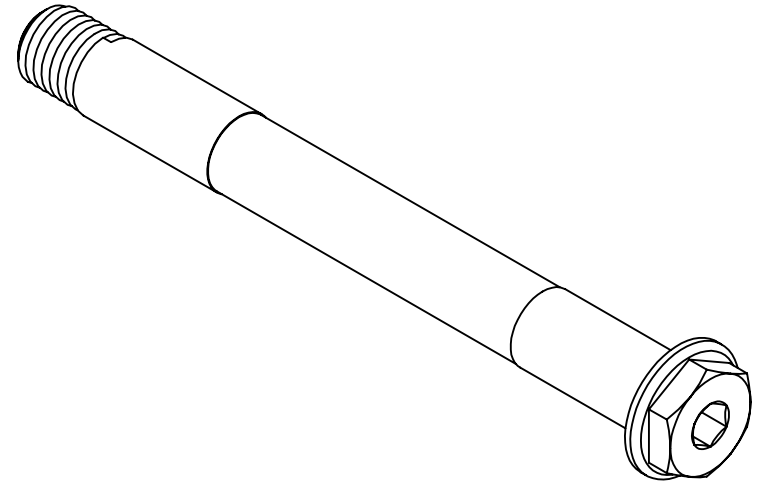

M12 x 1.5  
MAJOR DIA .4712/.4619

5mm INTERNAL  
HEXAGON  
.350in DEEP

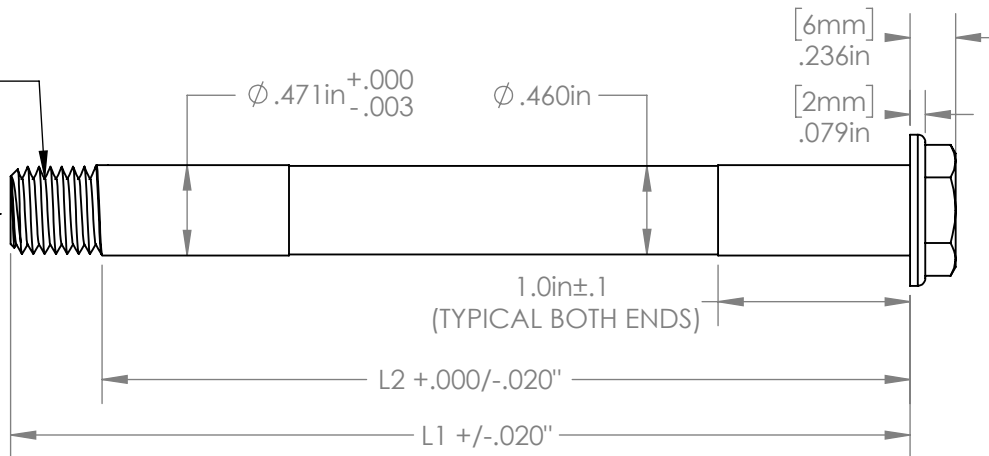

6mm INTERNAL  
HEXAGON  
.400in DEEP

15mm (.588)  
EXTERNAL  
HEXAGON

Ø .787in

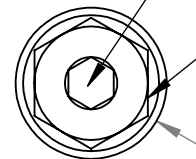

## PARAGON MACHINE WORKS

TITLE:

# 12 MM COMBINATION HEAD FRONT SKEWER

	NAME	DATE
DRAWN BY:	DN	9/2018
CHECKED BY:	MCN	9/2018

### PROPRIETARY AND CONFIDENTIAL

THE INFORMATION CONTAINED IN THIS DRAWING IS PROVIDED FOR FRAMEBUILDERS AND IS THE PROPERTY OF PARAGON MACHINE WORKS. ANY REPRODUCTION IN PART OR AS A WHOLE WITHOUT THE WRITTEN PERMISSION OF PARAGON MACHINE WORKS IS PROHIBITED.

MATERIAL: 6061 ALUMINUM

GENERAL TOLERANCES:

X.X ± 0.020"  
X.XX ± 0.010"  
X.XXX ± 0.005"

SIZE	DWG. NO.	REV
A	SK4001	A2

SCALE: 1:1

SHEET 1 OF 1