

COMPATIBLE FRAME COMPONENTS		
PART NUMBER		DESCRIPTION
PD000		6/4 Titanium
PD100		17/4 Stainless Steel
INSERTS		
PART NUMBER		DESCRIPTION
PA453 (BARE) PB4453 (BLACK)		Eyelets
ITEM NO.	PART NO.	EXPLODED VIEW
1	PD000UR	Upper Left Frame Component
2	PD000LR	Lower Left Frame Component
3	PA453	Eyelets
4	PDBOLT	M5 x .8 BHCS, QTY 5/Insert

See website for additional inserts.
Inserts and frame components
sold separately.

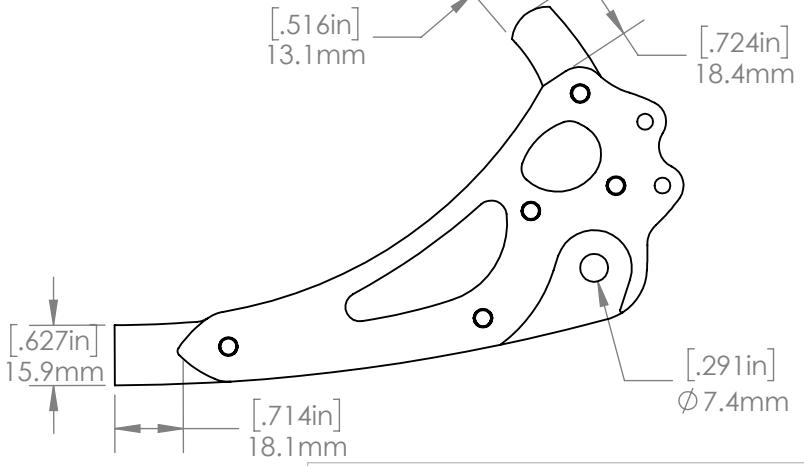
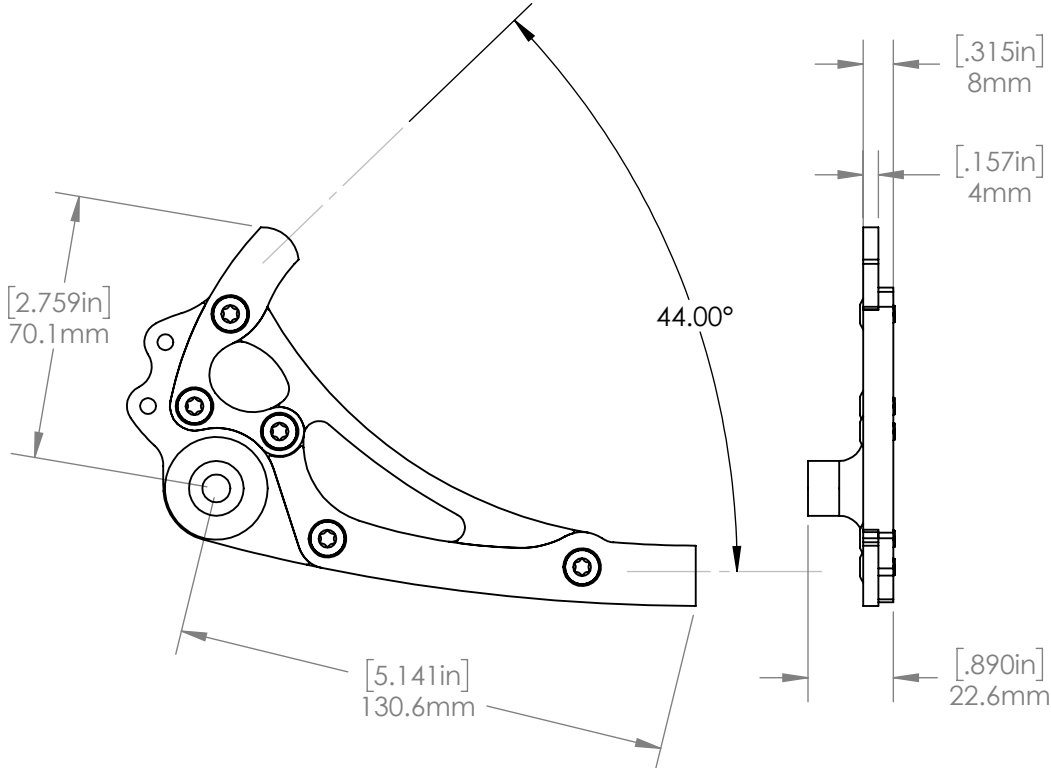
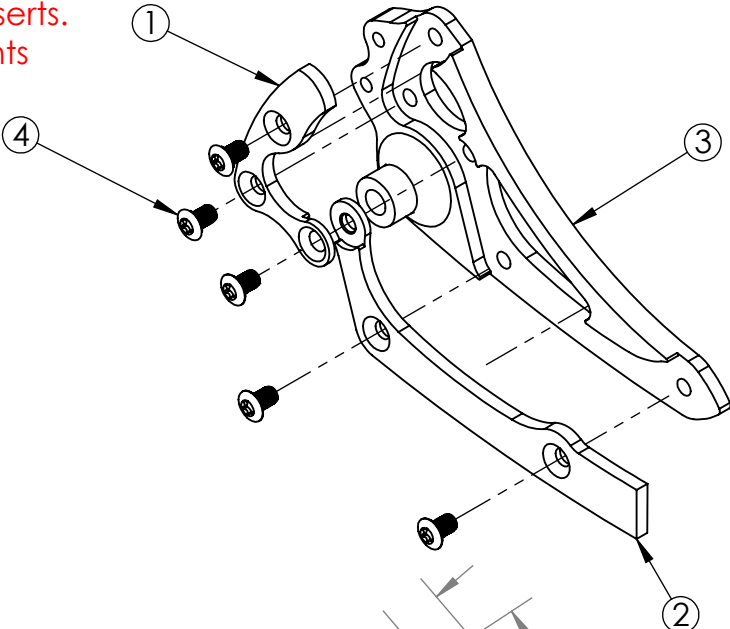

**PROPRIETARY AND
CONFIDENTIAL**

THE INFORMATION CONTAINED IN THIS
DRAWING IS PROVIDED FOR
FRAMEBUILDERS AND IS THE PROPERTY OF
PARAGON MACHINE WORKS. ANY
REPRODUCTION IN PART OR AS A WHOLE
WITHOUT THE WRITTEN PERMISSION OF
PARAGON MACHINE WORKS IS PROHIBITED.

	NAME	DATE
DRAWN BY:	DN	3/2019
CHECKED BY:	MCN	3/2019
MATERIAL: GENERAL TOLERANCES: X.X ± 0.020" X.XX ± 0.010" X.XXX ± 0.005"		

PARAGON MACHINE WORKS

TITLE: Right Side Insert,
PolyDrop, Eyelets,
Rohloff A12 Hub

SIZE	DWG. NO.	REV
A	PA453	A1
SCALE: 1:5		SHEET 1 OF 1