

M5 X .8 TAPPED (x7)

(.04", 1mm
WALL THICKNESS)

[159.5mm]
6.28in

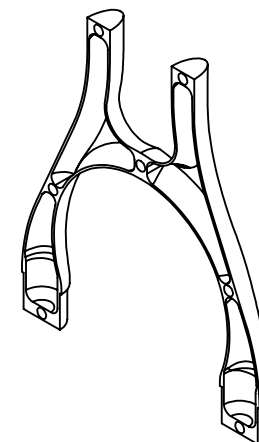
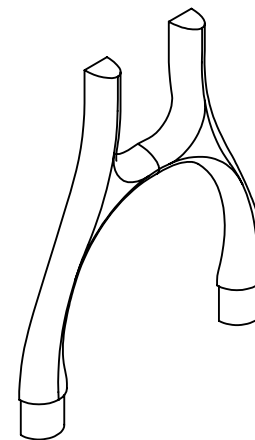
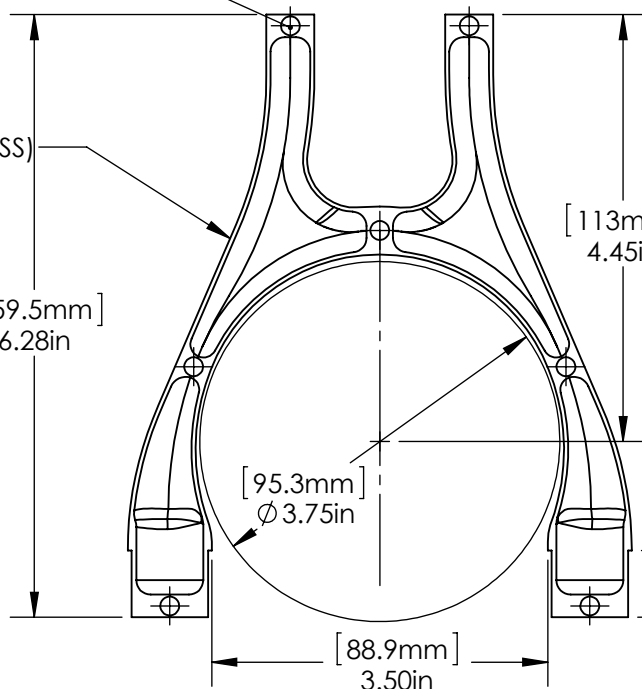

PARAGON MACHINE WORKS

TITLE:

CHAINSTAY YOKE
FOR 3" TIRES

	NAME	DATE
DRAWN BY:	SWS	03/03/15
CHECKED BY:	MCN	03/03/15

COMMENTS:

PROPRIETARY AND CONFIDENTIAL

THE INFORMATION CONTAINED IN THIS
DRAWING IS PROVIDED FOR
FRAMEBUILDERS AND IS THE PROPERTY OF
PARAGON MACHINE WORKS. ANY
REPRODUCTION IN PART OR AS A WHOLE
WITHOUT THE WRITTEN PERMISSION OF
PARAGON MACHINE WORKS IS PROHIBITED.

SIZE	DWG. NO.	REV
A	MS2060	A1

SCALE: 1:2

SHEET 1 OF 1