

COMPATIBLE LOW MOUNT DISC DROPOUTS		
PART #	MATERIAL	DESCRIPTION
DR2030	STEEL	48° EYELETS
DR1030	STAINLESS	
DR0030	TITANIUM	
DR2031	STEEL	58° EYELETS
DR1031	STAINLESS	
DR0031	TITANIUM	
DR2034	STEEL	48° NO EYELETS
DR1034	STAINLESS	
DR0034	TITANIUM	
DR2035	STEEL	58° NO EYELETS
DR1035	STAINLESS	
DR0035	TITANIUM	
COMPATIBLE ROUND, REAR DROPOUTS		
PART #	MATERIAL	DESCRIPTION
DR0004	TITANIUM	1-1/2" OD
DR2001	1018 STEEL	1-1/2" OD

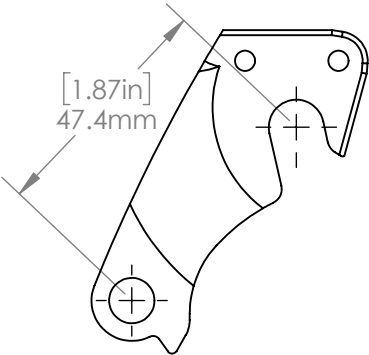

**SHIMANO DIRECT
MOUNT HANGER
ROAD**
B4135, DR4135

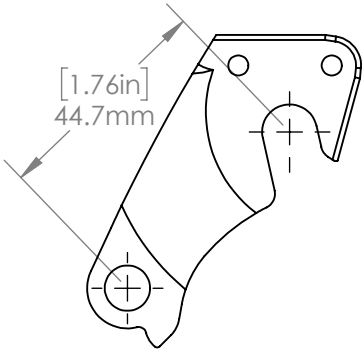

**SHIMANO DIRECT
MOUNT HANGER
MOUNTAIN**
B4134, DR4134

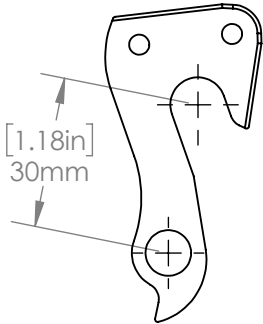

LONG HANGER
B4101, DR4101
DR2061 (STEEL)

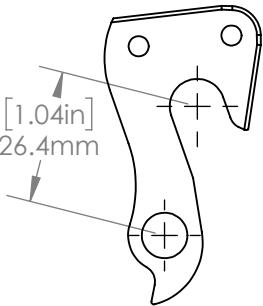

SHORT HANGER
B4102, DR4102
DR2062 (STEEL)

INCLUDED WITH HANGER: QTY 2 M4 x 8 FHCS

PARAGON MACHINE WORKS

TITLE:
HANGER OPTIONS FOR 10 MM
LOW MOUNT DISC AND 1-1/2"
ROUND, REAR DROPOUTS

SIZE	DWG. NO.	REV
A	HANGERS	

	NAME	DATE
DRAWN BY:	DN	2/2019
CHECKED BY:	MCN	2/2109

MATERIAL:
GENERAL TOLERANCES:
X.X ± 0.020"
X.XX ± 0.010"
X.XXX ± 0.005"

PROPRIETARY AND
CONFIDENTIAL

THE INFORMATION CONTAINED IN THIS
DRAWING IS PROVIDED FOR
FRAMEBUILDERS AND IS THE PROPERTY OF
PARAGON MACHINE WORKS. ANY
REPRODUCTION IN PART OR AS A WHOLE
WITHOUT THE WRITTEN PERMISSION OF
PARAGON MACHINE WORKS IS PROHIBITED.