

COMPATIBLE DROPOUTS		
PART #	MATERIAL	DESCRIPTION
DR0022	6/4 Titanium	Round, Rear 1-1/8" OD x 1in Flange Width
DR1022	17/4 Stainless	Round, Rear 1-1/8" OD x 22mm Flange Width
DR2023	4130 Steel	Round, Rear 1-1/8" OD x 17mm Flange Width
DR2070	4130 Steel	Flat Mount, 58°, No Eyelets
DR2071	4130 Steel	Flat Mount, 70°, No Eyelets

Hanger includes two M4 x 8 FHCS

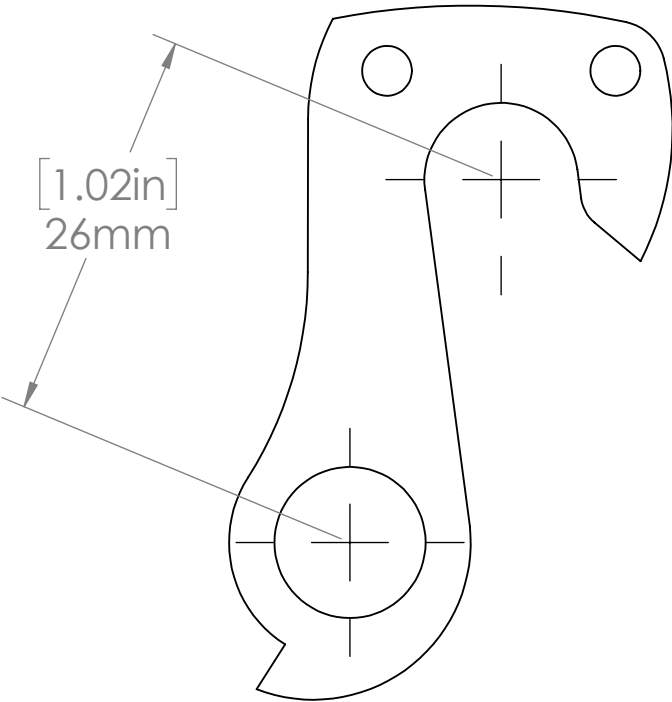

**Short Hanger**  
DR2064 (Steel)  
B4120, DR4120 (2024 Al)

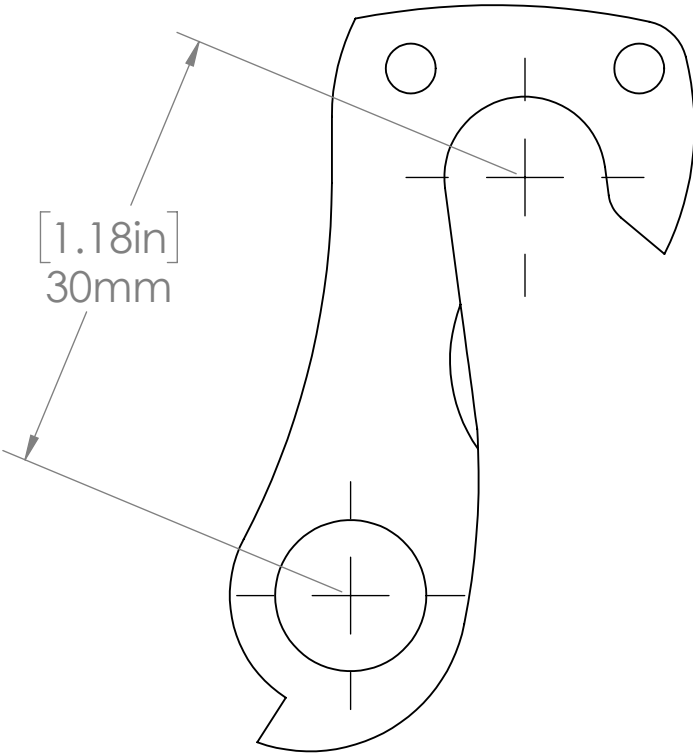

**Long Hanger**  
DR2063 (Steel)  
B4121, DR4121 (2024 Al)

	NAME	DATE
DRAWN	DN	2/2019
CHECKED	MCN	2/2019

**PROPRIETARY**  
THE INFORMATION CONTAINED  
IN THIS DRAWING IS PROVIDED  
FOR FRAMEBUILDERS AND IS THE  
SOLE PROPERTY OF PARAGON  
MACHINE WORKS. ANY  
REPRODUCTION IN PART OR AS A  
WHOLE WITHOUT THE WRITTEN  
PERMISSION OF PARAGON  
MACHINE WORKS IS PROHIBITED.

TITLE:  
HANGERS FOR 1-1/8"  
ROUND, REAR AND  
FLAT MOUNT DROPOUTS  
10 MM HUB

SIZE <b>C</b>	DWG. NO. DR4120_21	REV
------------------	-----------------------	-----

SCALE: 2:1

SHEET 1 OF 1