

PART NO.	DESCRIPTION	MATERIAL
DR0086	70°, No Eyelets	6/4 Titanium
DR0085	58°, No Eyelets	6/4 Titanium
BK0070	6/4 titanium flat mount caliper (included with DR0085, DR0086)	
DR1085	58°, No Eyelets	17/4 Stainless Steel
DR1086	70°, No Eyelets	17/4 Stainless Steel
DR1087	58°, With Eyelets	17/4 Stainless Steel
DR1088	70°, With Eyelets	17/4 Stainless Steel
BK1070	17/4 stainless steel flat mount caliper (included with DR1085, DR1086, DR1087, DR1088)	
DR2085	58°, No Eyelets	4130 Steel
DR2086	70°, No Eyelets	4130 Steel
DR2087	58°, With Eyelets	4130 Steel
DR2088	70°, With Eyelets	4130 Steel
BK2070	1018 steel flat mount caliper (included with DR2085, DR2086, DR2087, DR2088)	

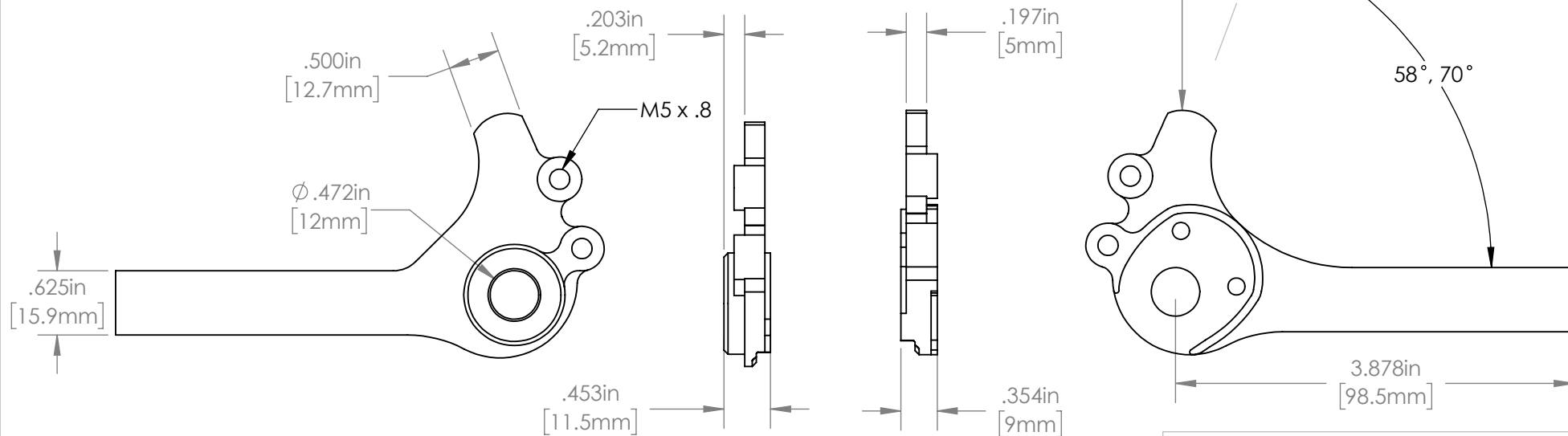

**PROPRIETARY AND  
CONFIDENTIAL**

THE INFORMATION CONTAINED IN THIS  
DRAWING IS PROVIDED FOR  
FRAMEBUILDERS AND IS THE PROPERTY OF  
PARAGON MACHINE WORKS. ANY  
REPRODUCTION IN PART OR AS A WHOLE  
WITHOUT THE WRITTEN PERMISSION OF  
PARAGON MACHINE WORKS IS PROHIBITED.

	NAME	DATE
DRAWN BY:	DN	11/2018
CHECKED BY:	MCN	11/2018

MATERIAL: SEE TABLE  
GENERAL TOLERANCES:  
X.X ± 0.020"  
X.XX ± 0.010"  
X.XXX ± 0.005"

**PARAGON MACHINE WORKS**

TITLE: 58 AND 70 DEGREE  
12 MM FLAT MOUNT  
DROPOUTS

SIZE	DWG. NO.	REV
A	DR208X	

SCALE: 2:3

SHEET 1 OF 1