

PART NUMBER	WIDTH "W"
DR2052	13mm [.512"]
DR2053	18mm [.710"]

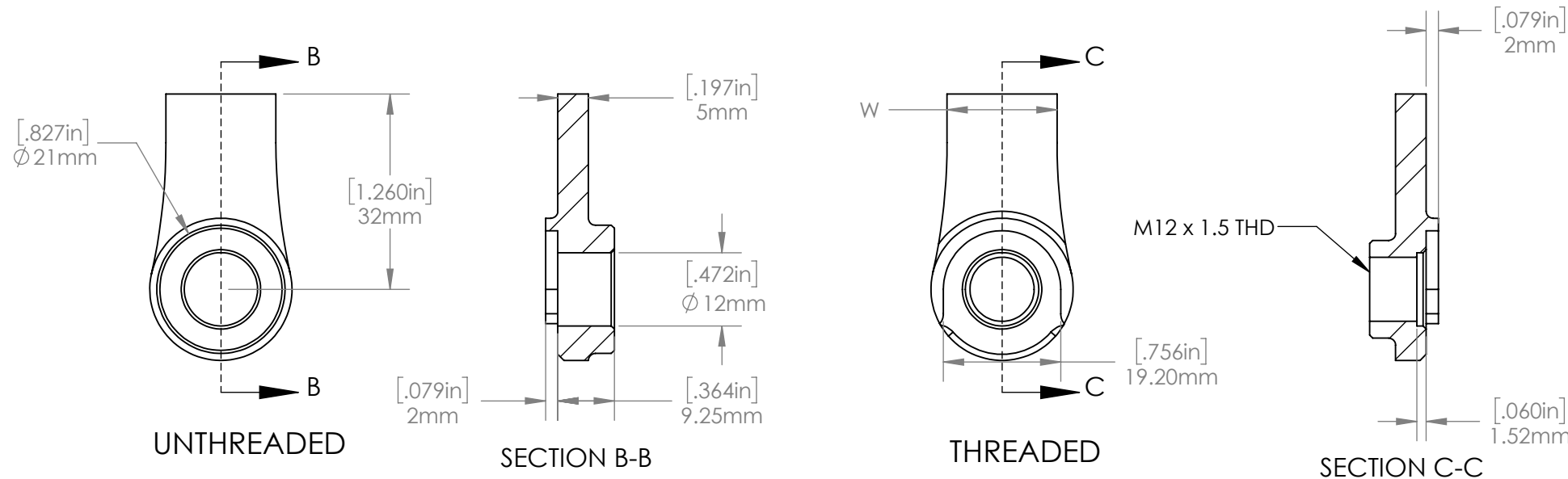

PARAGON MACHINE WORKS

TITLE:

FLAT FRONT DROPOUT,  
12MM

SIZE

DWG. NO.

REV

A

DR2052\_3

A7

SCALE: 1:1

SHEET 1 OF 1

PROPRIETARY AND  
CONFIDENTIAL

THE INFORMATION CONTAINED IN THIS  
DRAWING IS PROVIDED FOR  
FRAMEBUILDERS AND IS THE PROPERTY OF  
PARAGON MACHINE WORKS. ANY  
REPRODUCTION IN PART OR AS A WHOLE  
WITHOUT THE WRITTEN PERMISSION OF  
PARAGON MACHINE WORKS IS PROHIBITED.

MATERIALS:

DR2052 - 4130 STEEL

SK4001 - 6061 ALUMINUM

	NAME	DATE
DRAWN BY:	SWS	06/23/15
CHECKED BY:	MCN	06/23/15