

M12 x 1.5 INSERT OPTIONS FOR 1-1/2" ROUND, REAR DROPOUTS

PART NUMBER	DESCRIPTION	AXLE CENTER TO HANGER CENTER
B4079 (Black) DR4079 (Bare)	No Hanger	N/A
B4080 (Black) DR4080 (Bare)	Hanger	29.72 mm 1.17 in
B4081 (Black) DR4081 (Bare)	Shimano Direct Mount Mountain Hanger	44.27 mm 1.74 in
B4083 (Black) DR4083 (Bare)	Shimano Direct Mount Road Hanger	47.47 mm 1.87 in
B4191 (Black) DR4191 (Bare)	Hanger for SRAM Derailleur (shown)	33.50 mm 1.32 in

COMPATIBLE FRAME COMPONENTS

PART NO.	MATERIAL	DESCRIPTION
DR0065	6/4 Titanium	1.10in flange width
DR0066	6/4 Titanium	.906in flange width
DR1065	17/4 Stainless Steel	1.04in flange width
DR2065	1018 Steel	1.04in flange width

EXPLODED VIEW

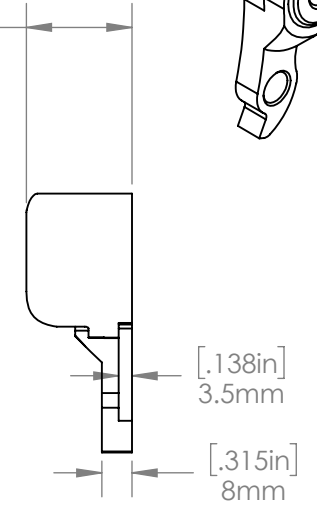
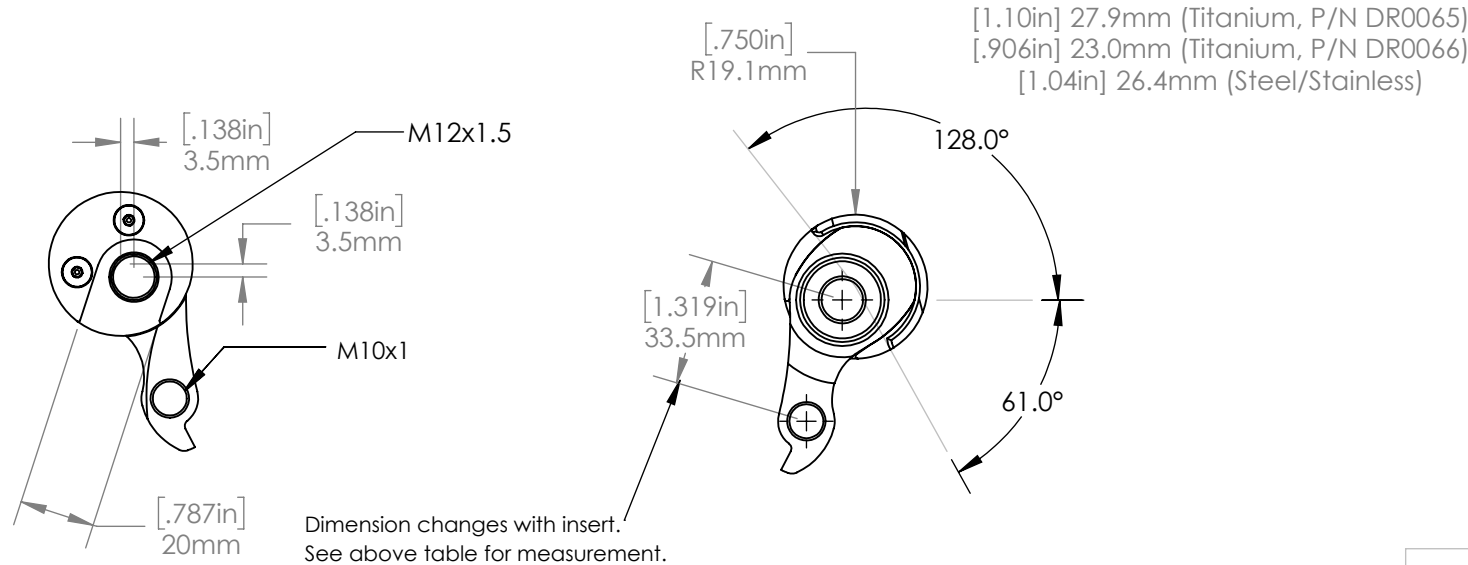
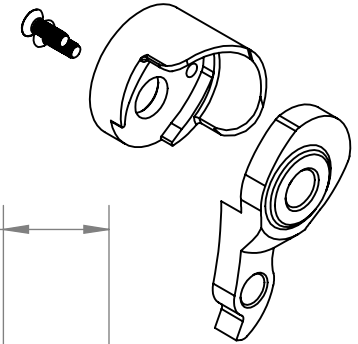

PARAGON MACHINE WORKS

TITLE: M12 x 1.5 INSERTS,
1-1/2" ROUND,
REAR DROPOUTS

	NAME	DATE
DRAWN BY:	DN	12/2018
CHECKED BY:	MCN	12/2018

MATERIAL: 6061 ALUMINUM
GENERAL TOLERANCES
X.X ± 0.020"
X.XX ± 0.010"
X.XXX ± 0.005"

PROPRIETARY AND CONFIDENTIAL
THE INFORMATION CONTAINED IN THIS DRAWING IS PROVIDED FOR FRAMEBUILDERS AND IS THE PROPERTY OF PARAGON MACHINE WORKS. ANY REPRODUCTION IN PART OR AS A WHOLE WITHOUT THE WRITTEN PERMISSION OF PARAGON MACHINE WORKS IS PROHIBITED.

SIZE	DWG. NO.	REV
A	DR0065	A1

SCALE: 2:3

SHEET 1 OF 1